

# QUICK SHIP SPEC SHEET

## FARETTO LARGE

LED



SPECIFICATION SHEET

PAGE: 1 OF 2

Project name: \_\_\_\_\_

Type: \_\_\_\_\_

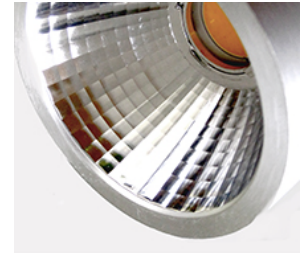

1690: 48°

### General information

#### Luminaire characteristics:

**Power input:** 22.5W (1690)

**Lumens:** 3000K: up to 1688 (delivered)

**Luminaire efficacy:** 3000K: up to 75lm/W, 80CRI

**Source:** Bridgelux vero18, 3000K: 80CRI.

**Lumen maintenance:** >70% of initial lumens at 50.000 hours (L70) LM-80 (LED) / LM-79 tested

**Configuration:** 330° vertical (pan), and 270° horizontal (tilt) pivoting axes with locking screws.

#### Optics:

**1690:** Aluminum faceted reflector: 48° beam with clear acrylic protection screen.

#### Mounting:

**Nordic track:** Track adaptor with circuit selector for TEK (120V) two circuit tracks.

**Body:** Aluminum housing and heatsink.

**Electrical:** Integral high efficiency dimmable driver, 120-277V.

**Dimming:** Compatible with Leading (TRIAC) and trailing edge (ELV) for 120V only.

#### Finish:

51: Natural matte anodized with black accent and black track adaptor.

52: Black matte anodized with black accent and black track adaptor.

**Weight:** 2.6 lbs. (1.15 Kg) including track adaptor.

**Warranty:** 5 years limited warranty.

**Certification:** cULus listed.

**Ratings:** Damp location.

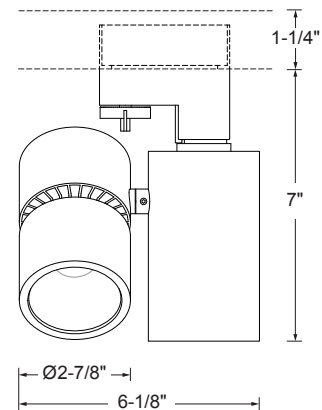

FRONT VIEW

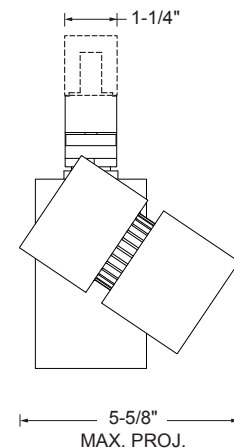

SIDE VIEW

DUE TO CONTINUOUS IMPROVEMENTS, THE INFORMATION HEREIN MAY BE CHANGED WITHOUT NOTICE.

LAST UPDATE: JUNE 15, 2014

MGD - R0

# SISTEMALUX



9320 Boul. St-Laurent,  
suite 100, Montréal (Québec)  
Canada H2N 1N7  
P.: 514.523.1339 F.: 514.525.6107  
www.sistemalux.com

# QUICK SHIP SPEC SHEET

## FARETTO LARGE

LED



Project name: \_\_\_\_\_

Type: \_\_\_\_\_

### TECHNICAL DATA

<b>Model:</b>	<b>1690-830-45-XXX-XX</b>
<b>Color temp.:</b>	3000K, 80CRI
<b>Optic:</b>	Flood beam, 48°
<b>Power input:</b>	22.5W
<b>Lumens:</b>	1620 lm (delivered)
<b>Luminaire efficacy:</b>	72 lm/W

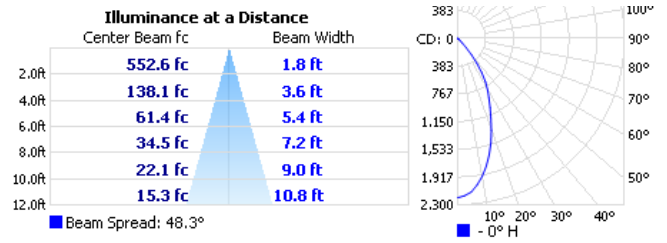

### ACCESSORIES (TO BE ORDERED SEPARATELY)

\* fixture can hold a maximum of 3 accessories at a time

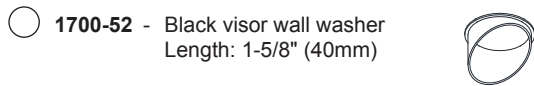
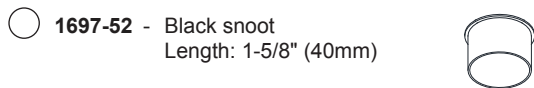
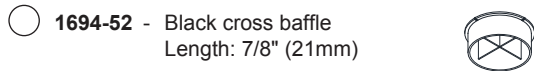
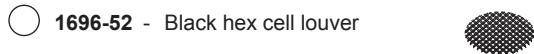
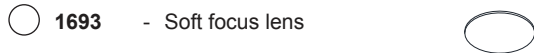
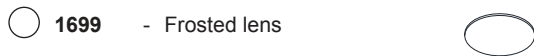

### ORDERING INFO

MODEL	LED	OPTIC	VOLTAGE	FINISH
<input type="radio"/> <b>1690</b> - Track	<input type="radio"/> <b>830</b> - 3000K, 80CRI	<input type="radio"/> <b>45</b> - 48°	<input type="radio"/> <b>120</b> - 120V	<input type="radio"/> <b>51</b> - Natural matte anodized <input type="radio"/> <b>52</b> - Black matte anodized

DUE TO CONTINUOUS IMPROVEMENTS, THE INFORMATION HEREIN MAY BE CHANGED WITHOUT NOTICE.

LAST UPDATE: JUNE 15, 2014

MGD - R0

# SISTEMALUX



9320 Boul. St-Laurent,  
suite 100, Montréal (Québec)  
Canada H2N 1N7  
P.: 514.523.1339 F.: 514.525.6107  
www.sistemalux.com